

Model: JF

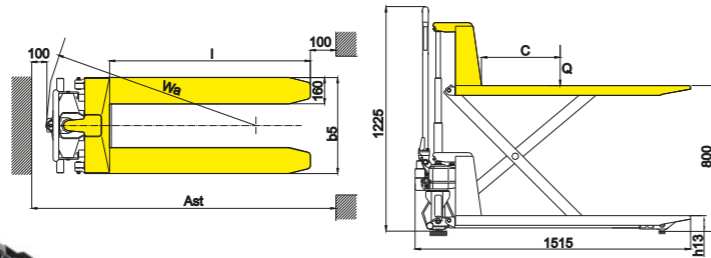

Conforms to EN ISO3691-5
Based on Directive 2006/42/EC

- Ideal design with numerous possibilities makes this unit very suitable as pallet truck/scissor lift table.
- Telescopic jack composes of 3 piston rods creating light pumping force giving great rigidity.
- Support legs come into operation automatically.
- It prevents the unit from moving when the forks are raised to keep the safety of the operator.
- Truck automatically slows the descending speed when heavy goods loaded to prevent cargo damage.
- 210 degree turning radius.
- 2 lateral stabilizers when raised ensure good stability.
- Option: Stainless Steel.



1KG=2.205LB 1INCH=25.40MM

Model		JF	JF7
Capacity	Q(kg)	1000	1000
Lowered fork height	h_{L_0} (mm)	85	85
Steering wheel	mm	Φ180X50	Φ180X50
Fork wheel	mm	Φ74X50	Φ74X50
Fork length	l (mm)	1150	1220
Width overall forks	b_0 (mm)	520/550/685	550/685
Aisle width for pallets 1000x1200 crossways	A_{c_0} (mm)	1715	1985
Aisle width for pallets 800x1200 lengthways	A_{l_0} (mm)	1765	1985
Turning radius	W_0 (mm)	1360	1670
Service weight	kg	104-115	104-115

Model: JF7

- Improved safety: Automatic activation of self adjusting stabilizers when lifting loads higher than 400 mm for maximum stability.
- Great stability: Extra long front legs increase the stability when handling unevenly loaded pallets.
- Quick-lift operation: Quick-lift function doubles the lifting speed when lifting loads less than 250kg.

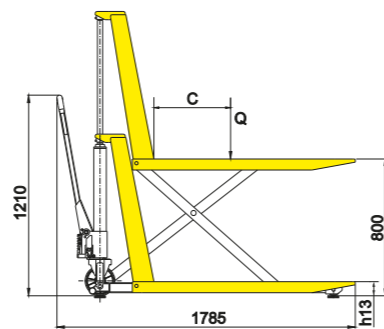

Model: JFD8



Conforms to EN ISO3691-1
EN1175-1
EN16307-1
Based on Directive 2006/42/EC

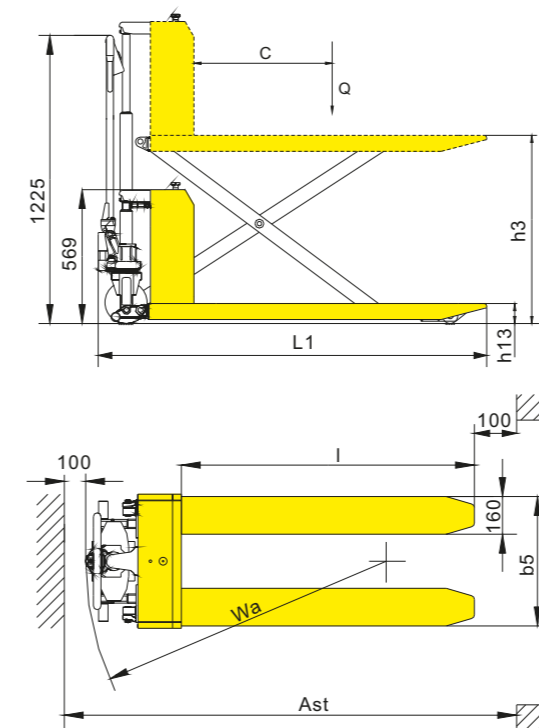

1KG=2.205LB 1INCH=25.40MM

Model		JFD8
Capacity	Q(kg)	1000
Lowered fork height	h_{L_0} (mm)	85
Steering wheel	mm	Φ180x50
Fork wheel	mm	Φ74x50
Max. lift height	h_0 (mm)	800
Overall length	L_0 (mm)	1652
Fork length	l (mm)	1245
Width overall forks	b_0 (mm)	550/685
Aisle width for pallets 1000x1200 crossways	A_{c_0} (mm)	1852
Aisle width for pallets 800x1200 lengthways	A_{l_0} (mm)	1852
Turning radius	W_0 (mm)	1480
Lift motor rating at S3 15%	kW	0.7
Battery voltage,nominal capacity K10	V/Ah	12/100
Battery weight	kg	31
Service weight (with battery)	kg	181