

## EU Type



Model: **SP150**

- Welded steel frame with durable coat finish.
- Durable hydraulic pump ensures a long service life.
- Robust casters with safety wheel guard enhance safety while operation.
- Easy action foot operated foot hydraulic pedal for raising the lift table to a desired height level.
- Safety back guard protects operators from dangers.
- With supporting plat on side of arm to ensure the safety service.
- Convenient finger release smoothly lowers even heavy loads.
- With over load by pass valve to protect operator and pump.



Conforms to EN 1570-1  
Based on Directive 2006/42/EC



Model: **SP800**  
**SP1000**  
**SP1500**



Model: **SP300**  
**SP500**

### Specification for EU type

1KG=2.205LB 1INCH=25.40MM

MODEL		SP150	SP300/SP500	SP800	SP1000	SP1500
Capacity	kg	150	300/500	800	1000	1500
Max. lift height	$h_{12}$ (mm)	740	900	1000	1000	1000
Min. height of table	$h_{11}$ (mm)	225	340	420	380	420
Lifting height	$h_2$ (mm)	515	560	580	620	580
Table size	$l \times b \times s$ (mm)	740x450x35	855x500x50	1000x510x55	1016x510x60	1220x610x60
Total height	$h_{14}$ (mm)	935	970	996	962	962
Overall length	$l_1$ (mm)	830	925	1150	1170	1379
Foot pedal cycles to max height		$\leq 25$	$\leq 32 / \leq 45$	$\leq 70$	$\leq 55$	$\leq 70$
Wheel diameter	$d$ (mm)	100	127	150	150	150
Qty. / 20' Container	PCS	192	120	52	52	48
Service weight	kg	44	82/87	115	115	135
Carton size	mm	880x480x265	950x530x390	1180x615x460	1180x615x430	1410x730x450

EU type SP150, SP300, SP500, SP800 in stead of old model SPA150, SPA300, SPA500, SPA800.

## U.S. Type



Model: **SP150**  
**SP300**  
**SP500**



Model: **SP200**



Model: **SP800**

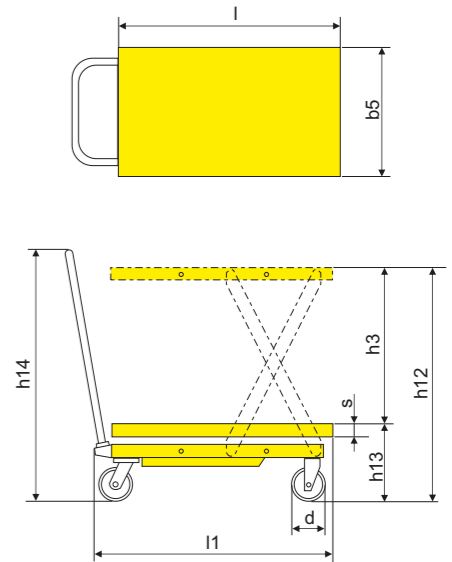

### Specification for U.S. type

1KG=2.205LB 1INCH=25.40MM

Model		SP150	SP200	SP300/SP500	SP800	SP500A*	SP500B*	SP500C*
Capacity	kg	150	200	300/500	800	500	500	500
Max. lift height	$h_{12}$ (mm)	740	1000	900	1000	900	1100	900
Min. height of table	$h_{11}$ (mm)	225	330	280	420	305	310	305
Lifting height	$h_2$ (mm)	515	670	620	580	595	790	595
Table size	$l \times b \times s$ (mm)	700x450x35	1000x500x35	815x500x50	1000x510x55	1050x700x52	1200x800x52	1050x850x52
Total height	$h_{14}$ (mm)	935	1056	996	996	970	970	970
Overall length	$l_1$ (mm)	770	1120	937	1150	1120	1270	1120
Foot pedal cycles to max height		$\leq 25$	$\leq 25$	$\leq 32 / \leq 45$	$\leq 70$	$\leq 55$	$\leq 55$	$\leq 55$
Wheel diameter	$d$ (mm)	100	200	127	150	127	127	127
Qty. / 20' Container	PCS	192	72	120	52	90	60	90
Service weight	kg	42	71	74.5/79.5	103	108	120	108
Carton size	mm	820x480x265	1140x620x460	960x530x420	1180x615x460	1150x730x330	1300x830x340	1150x880x330

\*Model SP500A, SP500B and SP500C are different on table size and lifting height.